

STC *Straightpoint Tension and Compression*



Features and benefits:

- Multiple weight capacity options: from 1t to 150t
- Polished Stainless Steel casing construction
- Ingress protection up to IP66 allowing for use in a variety of outdoor weather conditions (including high winds and heavy rain) *
- Compatible to fit standard metric rod-end bearing sizes
- Flexible bespoke options - customisable sizes and features
- Multiple tread options – including imperial and male or male/female end threads
- Additional option to include mating spherical rod-end bearings

* IP67 and submersible versions also available for use in marine environments

Ideal for measuring both tensile and compressive forces; the SP STC Series load cell has been engineered to the highest standards needed for exceedingly precise test results. The polished stainless steel casing provides durability and toughness for repeated use under a variety of conditions. The IP66 certificated ingress protection takes this robustness further by allowing the STC to be used outdoors in a variety of environmental conditions (dust winds, monsoon, snow, etc.), and also including indoor (carpenter workshops, refurbishments, water maintenance).

SP offer a large range of size options to cope with different levels of load forces to fit with all your specific measurement needs. Whatever your application, no matter how specific we can tailor the end threads to different sizes/combinations. End thread combinations are as shown:

Male to Male
Female to Female
Male to Female
Female to Male

Imperial thread sizes can also be supplied with the entire STC series.

SP will be more than happy to speak to you about your specific requirements for your job/project, and bring you the upmost confidence to match your requirements. SP can also provide an extensive range of associated products to help package a complete load monitoring/measuring system. This will, simultaneously, help you to ensure the highest level of safety precaution whilst working.

For example: When paired with the SA700C Load Cell Transmitter you will be able to wirelessly connect to the Handheld Plus (SW-HHP) digital handheld display and also to the SW-MWLC (Multiple Wireless Loadcell Controller) software package for the ultimate in remote load monitoring setups.



making the lifting industry a safer place

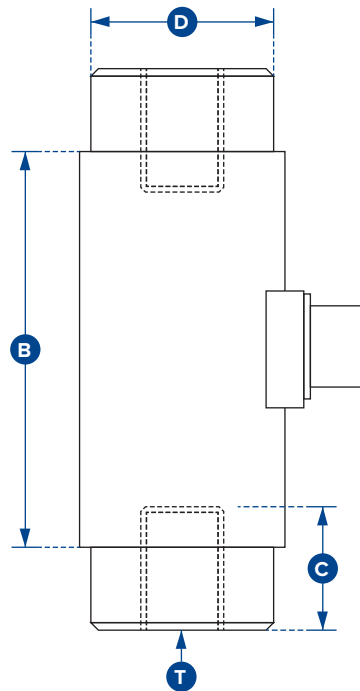

Rating (tonnes)	B	C	D	T	Weight (kgs)	Resolution (tonnes)
1	76	16	Ø31	M12 x 1.25	0.4	0.001
2	76	16	Ø31	M12 x 1.25	0.4	0.002
3	84	22	Ø38	M20 x 1.5	0.7	0.005
5	84	22	Ø38	M20 x 1.5	0.7	0.005
7.5	108	29	Ø44	M24 x 2	1.3	0.01
10	108	29	Ø44	M24 x 2	1.3	0.01
20	203	50	Ø57	M36 x 3	3.3	0.02
30	355	89	Ø114	M64 x 4	20	0.02
50	355	89	Ø114	M64 x 4	20	0.05
75	458	100	Ø130	M100 x 3	35.7	0.05
100	458	100	Ø130	M100 x 3	35.7	0.1
150	458	100	Ø156	M100 x 3	40.5	0.2

Rated load (tonnes)	1, 2, 3, 5, 7.5, 10, 20, 30, 50, 75, 100, 150
Proof load	150% of rated load
Ultimate breaking load	>300% of rated load
Output	1.5mV/V [±0.1%]
Accuracy	<±0.2% of rated load
Non-repeatability	<±0.1% of rated load
Excitation voltage	10vdc recommended, 15vdc maximum
Bridge resistance	1te: 350Ω, 20 to 50te: 700Ω, 75 to 150te: 1400Ω
Insulation resistance	>500MΩ @ 500vdc
Operating temperature range	-20°C to +70°C
Compensated temperature range	-10°C to +50°C
Zero temperature coefficient	<±0.01% of rated load/°C
Span temperature coefficient	<±0.01% of rated load/°C
Environmental protection level	IP66 [IP67 optional]
Connection type	Integrated bayonet lock connector, supplied with 5 metre mating cable assembly
Wiring connections	+supply: Red, -supply: Blue, +signal: Green, -signal: Yellow

Note: Default calibration of load cells rated up to 20 tonnes will be in tension. STCs rated 30 tonnes and above will be in compression. If you require calibration in a different mode to the standard or in both tension and compression, please state at time of order (additional charges may apply).